

# IB HERA BOARD

*Your Smart Choice!*

**100%**   
ASBESTOS FREE

**100%**   
RAW MATERIALS



# PRODUCT CATALOGUE

*Fiber Cement Board*



[www.globalsource.com.ph](http://www.globalsource.com.ph)

# HERA BOARD



The certification that HERA BOARD had conformed with:



Green Label Certificate from Green Product Council Indonesia.

ISO 9001: 2015 for design/develop and manufacture of non asbestos fiber cement boards.



CE Mark Certificate.



ISO 140; Measurement of sound Insulation in buildings and building elements.



ASBESTOS  
FREE



STRONG &  
DURABLE



MOISTURE  
RESISTANT



EASY  
APPLICATION



AIR-CURED



SOUND  
INSULATION



MOLDS  
RESISTANT



TERMITE  
RESISTANT



SMOOTH  
SURFACE



FIRE  
RESISTANT

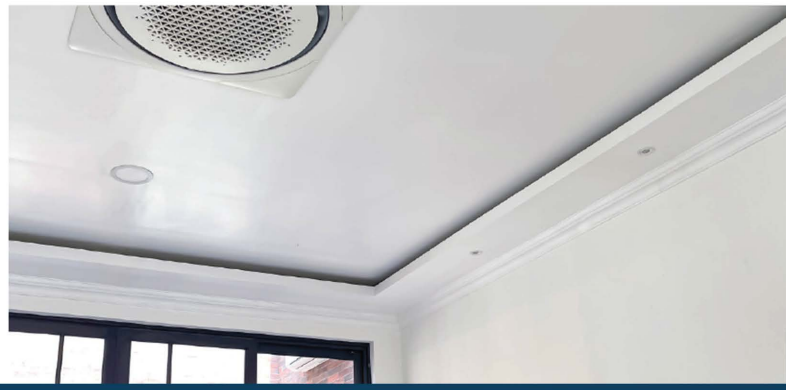
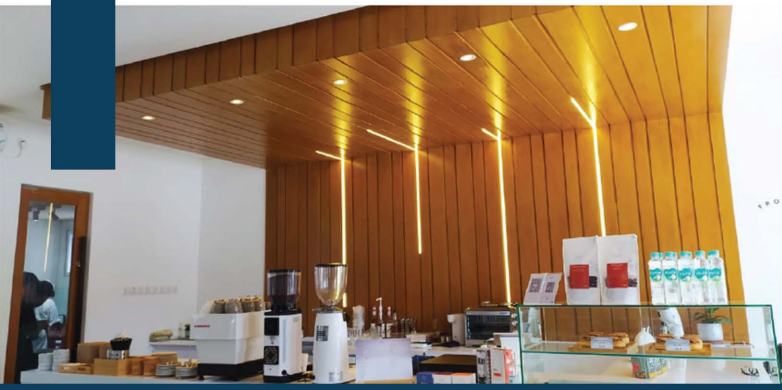

## BOARD

**HERA BOARD** is an asbestos free fiber reinforced cement board which is safe for health and environment-friendly. It is lightweight, resistant to humidity and strong.



**HERA BOARD**

Size(mm) T x W x L	Weight (kg)	Application
3.5 x 1220 x 2440 mm	17	Ceiling
4.5 x 1220 x 2440 mm	21.5	Ceiling/Partition
6 x 1220 x 2440 / 3000 mm	28/34	Ceiling/Partition



**HERA BRICK**

<b>Thickness</b>	9 & 10 mm
<b>Width</b>	1200 mm (max)
<b>Length</b>	2400 mm (max)



**HERA LINEA**

<b>Thickness</b>	9 & 10 mm
<b>Width</b>	1200 mm (max)
<b>Length</b>	2400 mm (max)

\* Customized dimensions & thickness options are available with conditions applied.



03.

## WALL APPLICATION

### Frames

#### Metal Furring Frames

75 x 45 mm thickness 1.6 mm

#### Hallow Frames

60 x 40 mm thickness 1.6 mm

#### Angle Bar

50 x 50 mm thickness 5mm (min).

### Detail Application

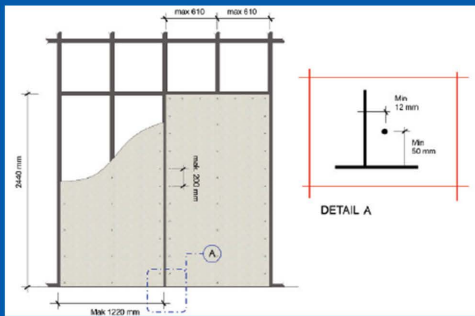

## LINEA APPLICATION

### Frames

#### Hallow Frames

60 x 40 mm thickness 1.2 mm

### Detail Position

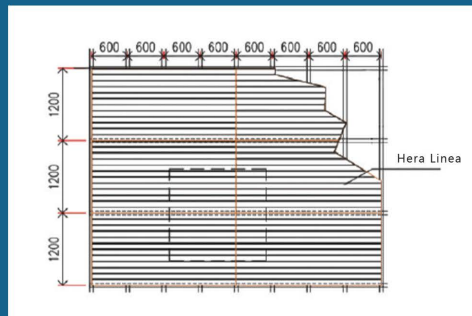

## BRICK APPLICATION

### Frames

#### Hallow Frames

60 x 40 mm thickness 1.2 mm

### Detail Position

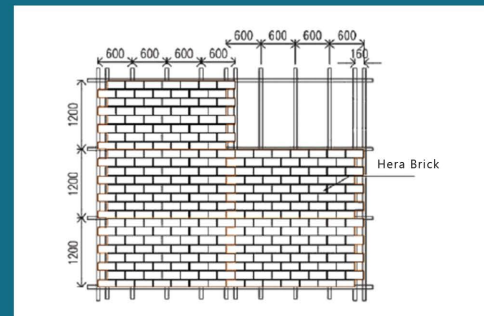

## CEILING APPLICATION

### Frames

#### Wood Frames

40/60 mm 50/70 mm

#### Hallow Frames

40/40 mm & 20/40 mm  
min. thickness 0.35 mm

### Detail Application

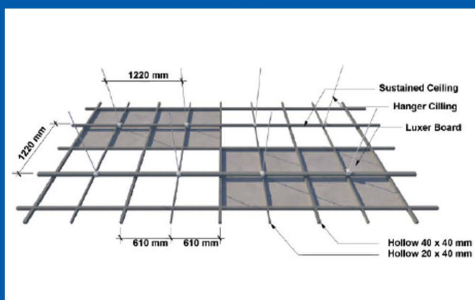

### Screw Position

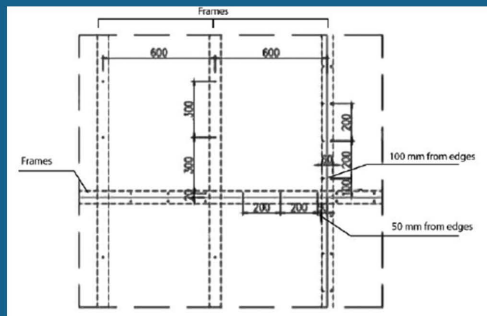

### Finishing

For Paint Finishing on HERA LINEA, water-based or oil-based paint can be applied

### Screw Position

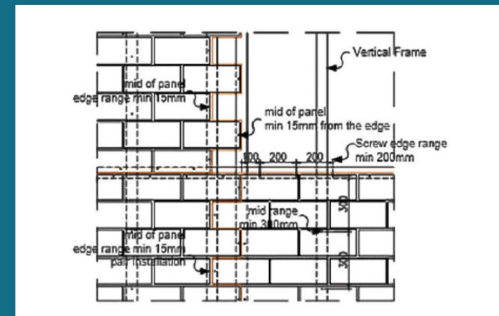

### Finishing

For Paint Finishing on HERA BRICK, water-based or oil-based paint can be applied



## PLANK & PLINT

**HERA BOARD PLANK & PLINT** are used for interior applications not exposed to weather siding and baseboards (plint), such as wall ceiling, wall decoration. Profile options are HERA SEDA, HERA CHANFRO, HERA MAHONI, HERA ROSHA and HERA DEKO.

### HERA SEDA

Size (mm) T x W x L	Weight (kg)
8 x 100 x 2440 mm	3.4
8 x 200 x 2440 / 3000 / 4000 mm	6.8
8 x 300 x 2440 / 3000 / 4000mm	8.4

### HERA CHANFRO

Size (mm) T x W x L	Weight (kg)
9 x 75 x 2440 mm	2.8
9 x 100 x 2440 mm	3.8
9 x 200 x 2440 mm	7.5
9 x 300 x 2440 mm	11.3

### HERA MAHONI

Size (mm) T x W x L	Weight (kg)
8 x 100 x 3000 mm	3
8 x 200 x 3000 mm	8
8 x 300 x 3000 mm	11

### HERA ROSHA

Size (mm) T x W x L	Weight (kg)
8 x 200 x 3000 / 4000 mm	7.5
8 x 300 x 3000 / 4000 mm	11.3

### HERA DEKO

Thickness	9 mm
Width	200,300 mm (max)
Length	1200 mm (max)

\* Customized dimensions & thickness options are available with conditions applied.

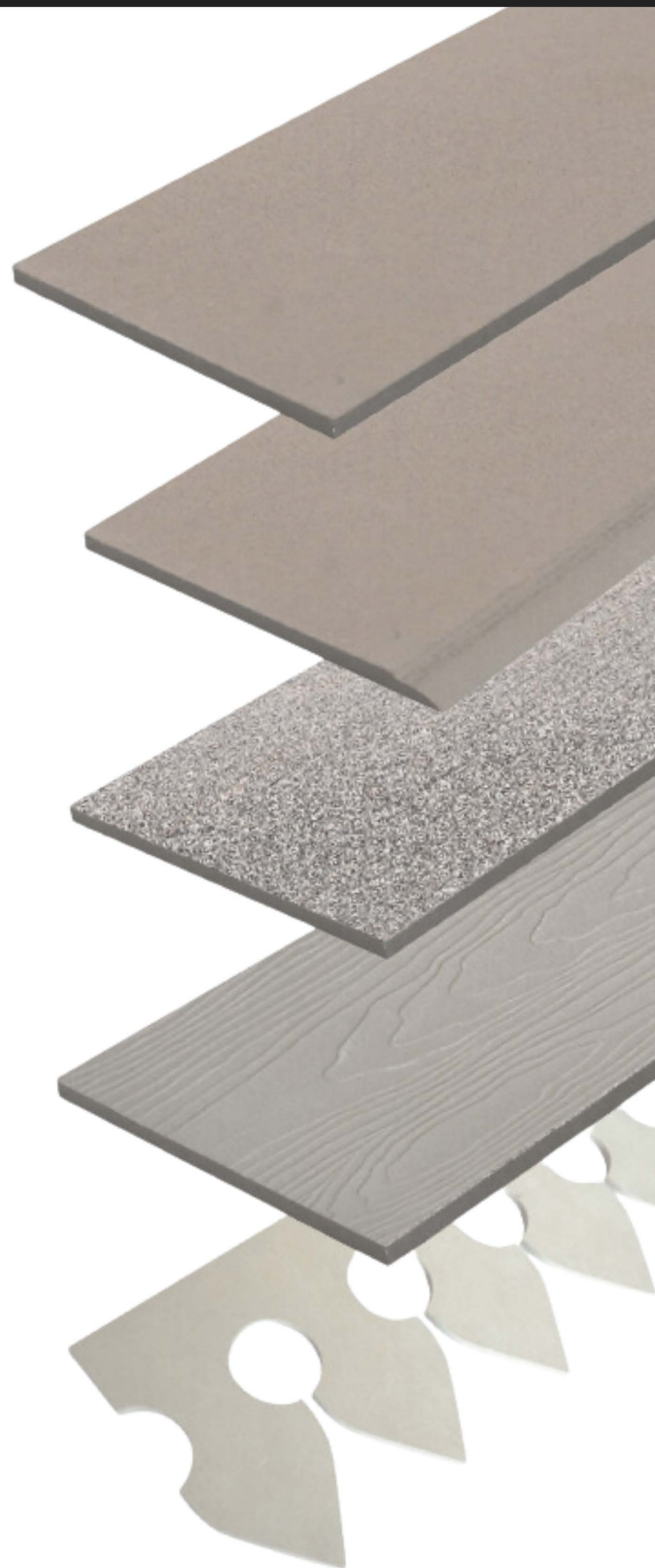



## PLINTH APPLICATION

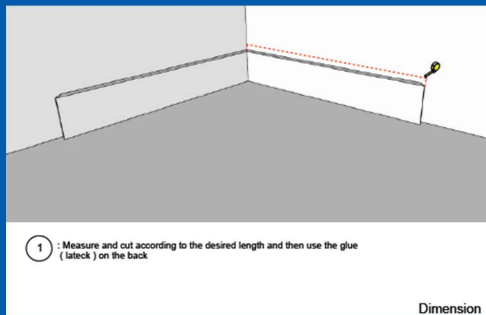

Dimension

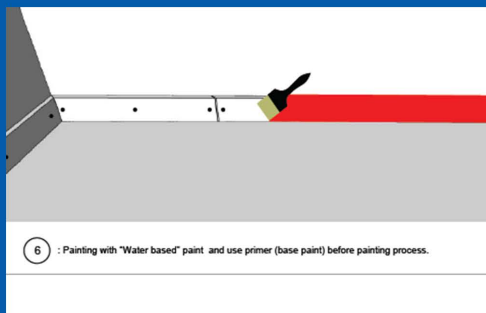
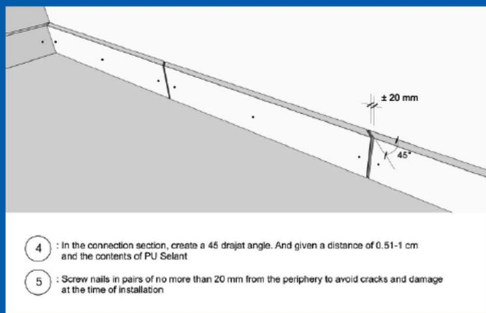
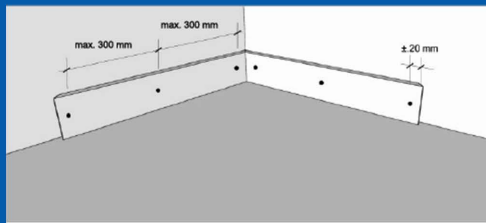

## SIDING APPLICATION

### Frames

#### Wood Frames

50 x 70 mm thickness 1.6 mm

#### Metal Framework

thickness 1.2 mm

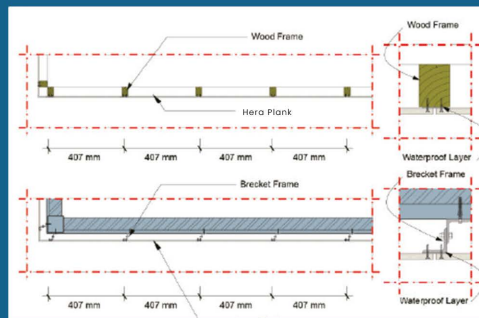

### Installation

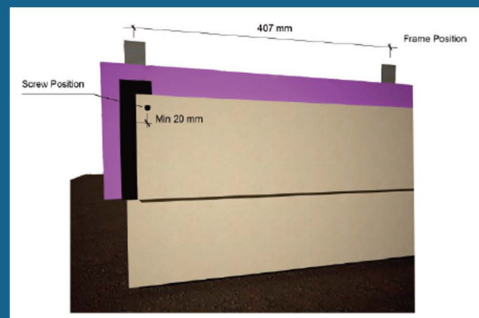

### Joining

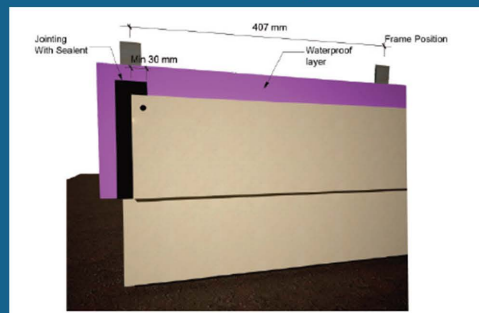

## CEILING GRID APPLICATION

### Frames

#### Wood Frames

50 x 70 mm thickness 1.6 mm

#### Hallow Frames

40 x 40 mm thickness 0.6 mm

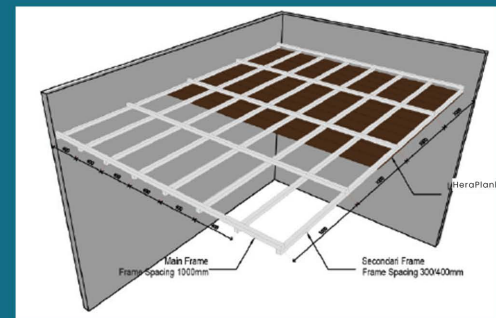

### Installation

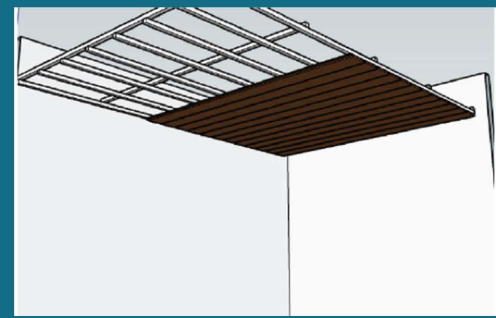

# HERA INTERLOCK

HERA INTERLOCK can be installed as facades and sidings with perfectly smooth and beautiful lines. With HERA INTERLOCK, achieving great aesthetic finish for your walls is easy and efficient.

06.

## HERA INTERLOCK SEDA

**Thickness** 10 mm

**Width** 150, 200, 300 mm

**Length** 3000 mm

Texture : Smooth, Plain

## HERA INTERLOCK ROSHA

**Thickness** 10 mm

**Width** 150, 200, 300 mm

**Length** 3000 mm

Texture : Variable Grain

## HERA INTERLOCK MAHONI

**Thickness** 10 mm

**Width** 150, 200, 300 mm

**Length** 3000 mm

Texture : Straight Grain



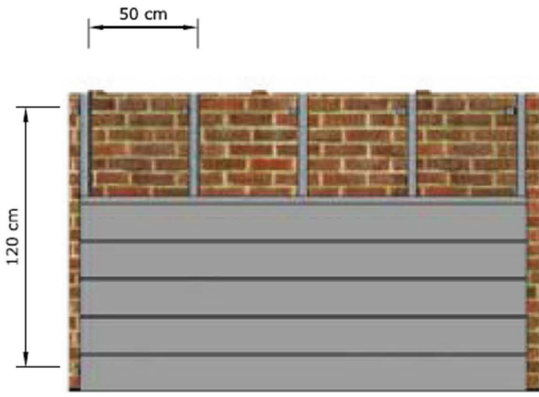

## INTERLOCK APPLICATION

### FRAMES

1. **Metal Stud Frames** 40/60 mm or 50/70 mm.
2. **Hollow Frames** combination of 40/40 mm and 20/40 mm which has minimum thickness of 0.35 mm.

## INTERLOCK SCREW POSITION

1. Screw with a distance of 20mm from the edge of the top board tongue.
2. Oversunk to a depth of 5mm before screwing with a large diameter drill.

## INTERLOCK INSTALLATION

Install the next board right on the "tongue and groove". Give a 5-10 mm or 0.5 cm-1cm gap between each panel.



# HERA DECK

**HERA DECK** is a versatile fiber cement board panel that is the best replacement for wooden deck panels. It can be installed for interior areas and efficiently on exterior areas with its high moisture that prevents insects and weathering.

Size (mm) T x W x L	Weight (kg)
20 x 200 x 2400 mm	16.4
20 x 300 x 2400 mm	24.6

Surface Finish: Smooth Straight Grain Pattern  
Smooth Plain



**HERA DECK MAHONI**

**HERA DECK LISO**

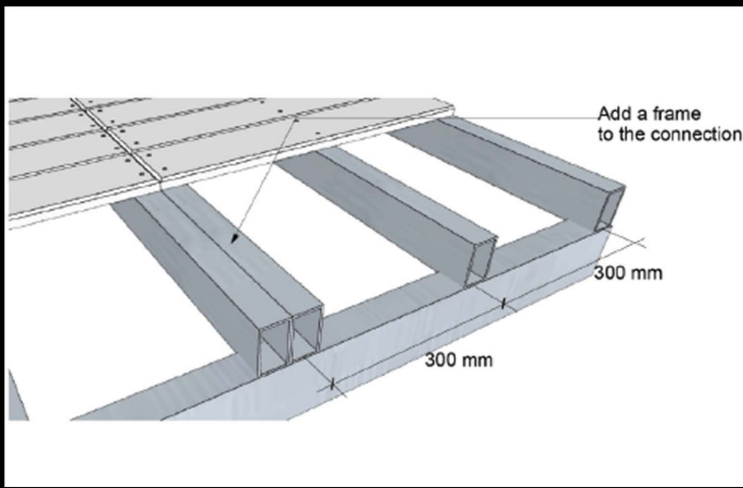

**DETAIL APPLICATION**

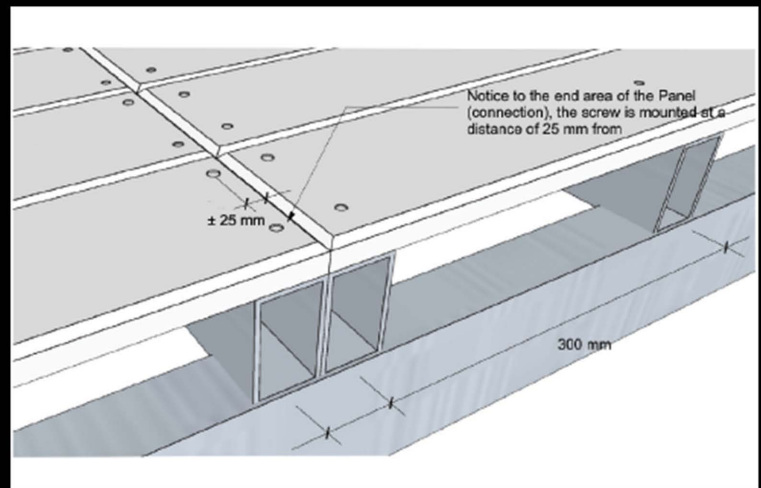

**SCREW POSITION**

## DECK APPLICATION

### FRAMES

**Metal Frame** CNP 100-125, Thickness 2-3 cm.  
 The installation maximum recommended spacing  
 for support frame is 300 mm (please refer to diagram above)





## FLOOR

**HERA FLOOR** is a thick and compressively strong cement board highly suitable to be used as interior floor surface panels.

Size (mm) T x W x L	Weight (kg)
15 x 1220 x 2440 mm	78.4
20 x 1220 x 2440 mm	104.7

Surface Finish: Smooth, Square Edge

*\* Customized dimensions & thickness options are available with conditions applied.*

**HERA FLOOR**





## FRAMES

Light Metal Framework, thickness: 2.3mm.  
Hollow Steel and CNP: thickness min. 2.3 .

The installation of frame recommended for:  
15 mm thickness - maximum 407mm x 817mm  
20mm thickness - maximum 610mm x 1220mm

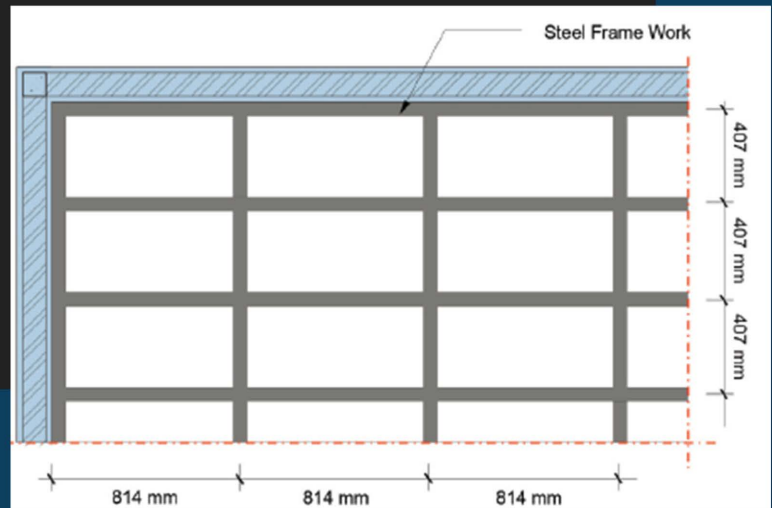

## SCREW POSITION

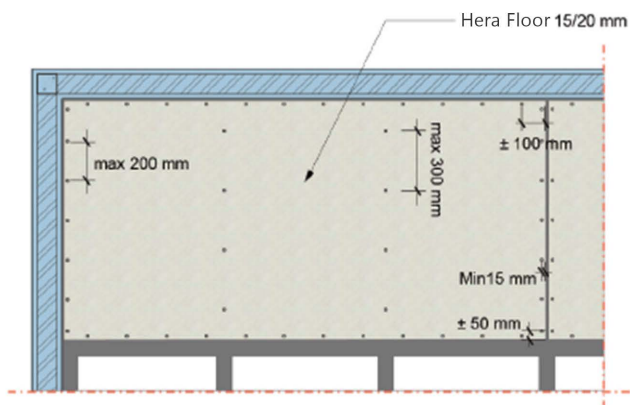

## DETAIL APPLICATION

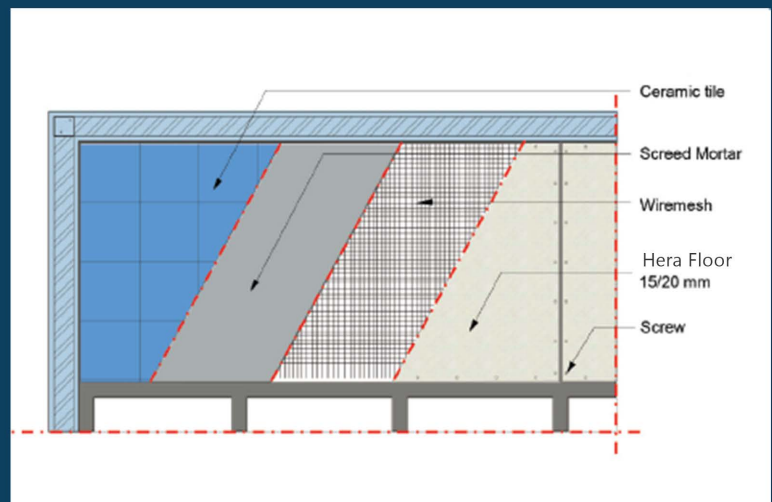

# CLADDING

**HERA CLAD** is a resilient cement board used for external wall applications. Thickness options are designed to make it strong and resistant to weather. Smooth surface on both sides. HERA CLAD enables convenient and efficient paint applications.

Size (mm) T x W x L	Weight (kg)
9 x 1220 x 2440 mm	45.5
12 x 1220 x 2440 mm	62.6

Surface Finish: Smooth & Plain Square

*\* Customized dimensions & thickness options are available with conditions applied.*



12.

## HERA CLAD



### CLADDING APPLICATION

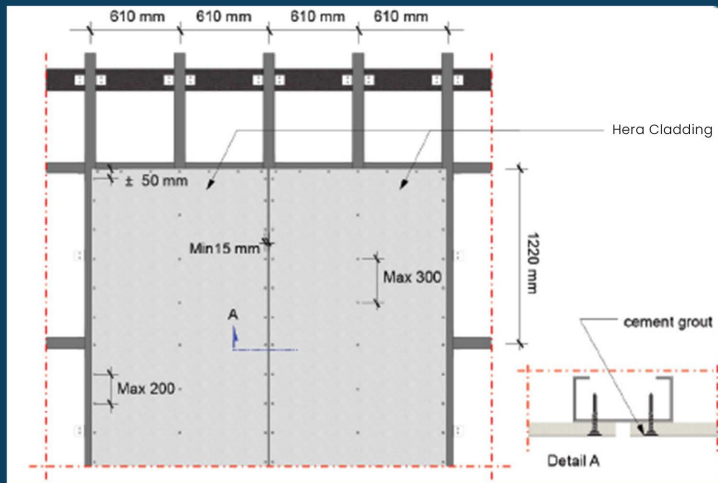

### SCREW POSITION

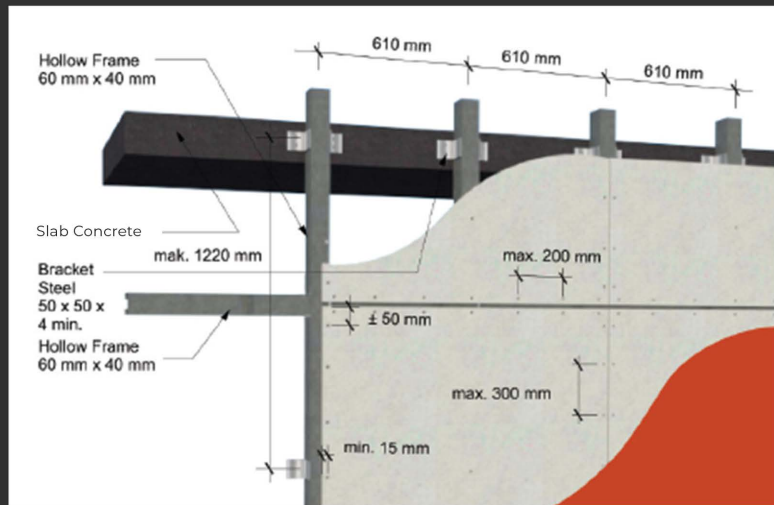

### FRAMES

Vertical Frame components:

1. Furring channel 75 x 45 x 1.6 mm.
2. Hollow Pipe 60 x 40 x 1.6 mm (min).
3. L-Bracket 50 x 50 x 5 mm (min).

Horizontal Frame can be of metal frame CNP 75, 100, 125.

1. Distance - 610 mm maximum
2. Distance - 1220 mm maximum

### DETAIL APPLICATION

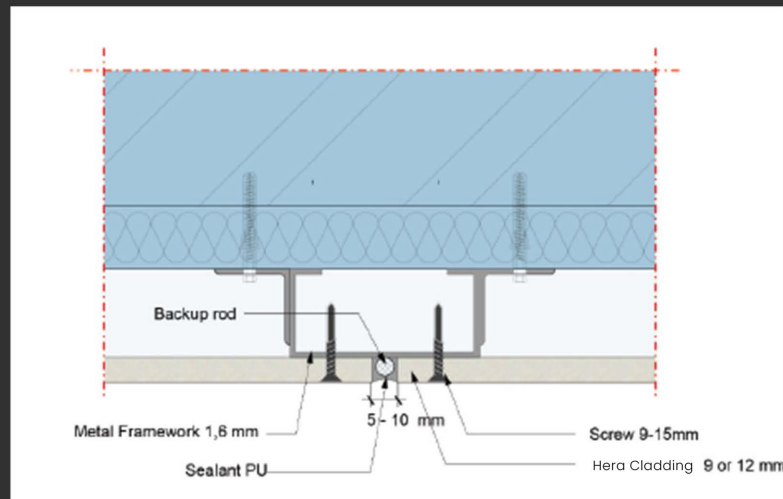



## DECORATIVE FACADE

**HERA DEKO** cement board breaks boundaries in creating astonishing interior and exterior building facades. The wide range of design and size options elevates the aesthetic values of any building. With HERA DEKO, customized designs and sizes are limitless.



**HERA DEKO**

<b>Thickness</b>	6-20 mm
------------------	---------

<b>Width</b>	1200 mm (max)
--------------	---------------

<b>Length</b>	2400 mm (max)
---------------	---------------

*\* Customized dimensions & thickness options are available with conditions applied.*



**Compound A+B** is a glue used as grout to fill the gap between HERA BOARD connections. This will ensure prevention of cracks between connections of HERA BOARD.

**HERA TAPE** is a fiber tape used to strengthen the connections. It is installed on top of grout connections after application of compound A+B.

**HERA PUTTY** is a Pre-mixed Mortar made from white cement which is specially formulated as final coat or finish coat on various types of cement-based walls (HERA BOARD), and plastered concrete. It is safe to use on interior and exterior areas.

#### **HERA Screw 4mm**

These screws are for installation of 4mm HERA BOARD.

#### **HERA Screw 5-8mm**

These screws are for installation of 5mm to 8mm HERA BOARD and not recommended for boards 4mm thick.

#### **HERA Screw 9-15mm**

These screws are for installation of boards that have a thickness between 9-15mm.

#### **HERA Screw 15-20mm**

These screws are for installation of boards that have a thickness between 15mm to 20mm.

**HERA Nail** is suitable for use on ceilings and partitions mounted on wood frames. It has a larger and thinner head design that makes nailing easy and convenient. Hera Nail is galvanized with anti-rust properties and is available in two types for board and plank applications.

# TECHNICAL DATA

Property Items	Value of Test	Standard
<b>Tolerance of Thickness:</b>		
≤ 10 mm	± 0.3 mm	ISO 8336 ; 2009
> 10 mm	± 5%	ISO 8336 ; 2009
Tolerance of Length	+ 0 ; -2 mm	ISO 8336 ; 2009
Tolerance of Width	+ 0 ; -2 mm	ISO 8336 ; 2009
Tolerance of Squareness	≤ 3 mm	ISO 8336 ; 2009
Tolerance of Straightness	≤ 1.5 mm	ISO 8336 ; 2009
Density	> 1.4 gr/cm <sup>3</sup>	ISO 8336 ; 2009
Modulus of Rupture	> 100 kg/cm <sup>2</sup>	ISO 8336 ; 2009
Water Absorption	23 - 25 %	ASTM C1186
Water Content	6-9 %	ASTM C1186
Non combustible	Pass	BS 476 Part 4 :1970

## PRODUCT GUARANTEE

We guarantee that our products are sold in good condition without damage or fault caused by faulty production or its raw materials.

This product warranty does not cover damages caused by:

1. Transportation and/or its agent sending the goods to the customer as it is out of the company's control.
2. Installation quality system of workers as various factors affect good and standard installation system.
3. Suitability of our product on particular application that is beyond our application recommendations.

*Distributed by:*



*Subsidiaries :*

